

## Flux Drive Magnetic Disc Coupling

### ANSI Standard Flexible Coupling with Soft Start & Energy Saving Capability

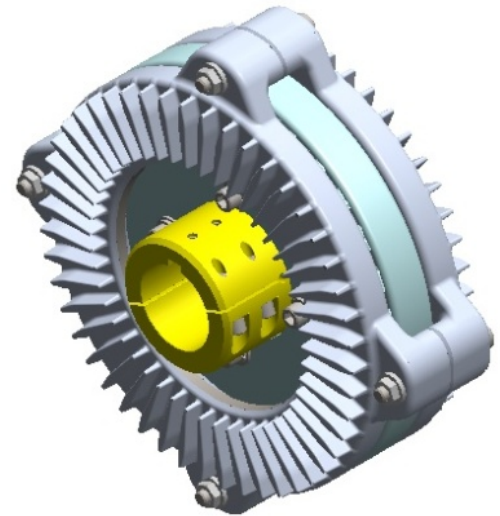

Flux Drive's patented induction rotor technology has now been applied to an affordable and easy-to-install soft-start coupling - the Flux Drive Disc Coupling (FDC).

Designed to replace rigid or elastomeric couplings in applications with ANSI-standard Distance Between Shaft Ends (DBSE), the FDC transfers torque across an air gap by means of magnetic induction – completely isolating the motor from the load. Vibration and torsional stress are nearly eliminated, reducing expensive downtime from failed bearings, seals, broken shafts and damaged couplings. Locked rotor current at start-up is also limited, potentially reducing costly utility demand charges (kW).

For applications that can benefit from reduced speed, the FDC also offers unique adjustment spacers that decrease the magnetic coupling effect. This gives operators the ability to extend soft-start duration and/or trim operating speed by up to 20%. Since the FDC follows the Laws of Affinity on centrifugal loads, **trimming the load speed by just 10% could result in as much as 25% energy (kWh) savings!**

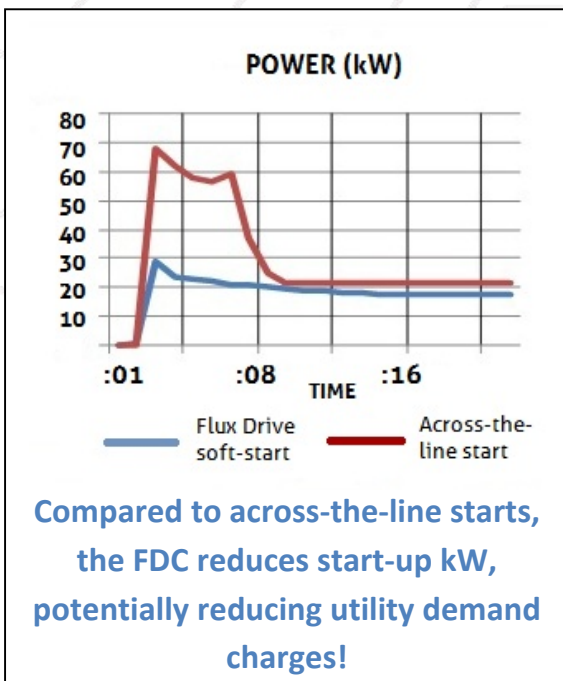

### Benefits

- Provides soft-start of driven loads
- Ability to reduced speed & save energy
- Runs with misalignment
- Protects against damage from load shaft seizures
- Eliminates transmission of vibration between motor and load
- Not affected by power spikes, sags, or 'dirty' power
- High operating efficiencies
- Reduces equipment maintenance and extends life
- **A truly 'Green' technology that...**
- **Never Wears Out!**

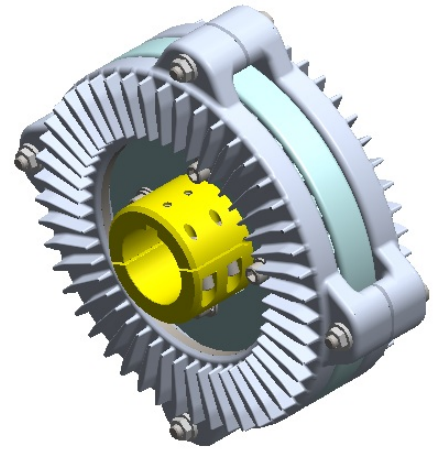
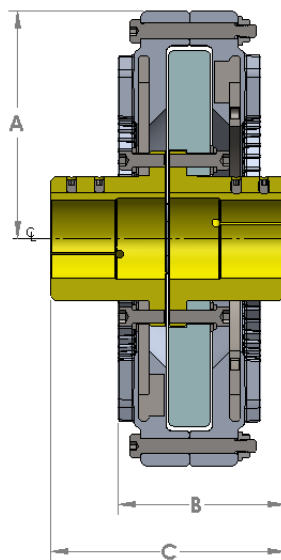
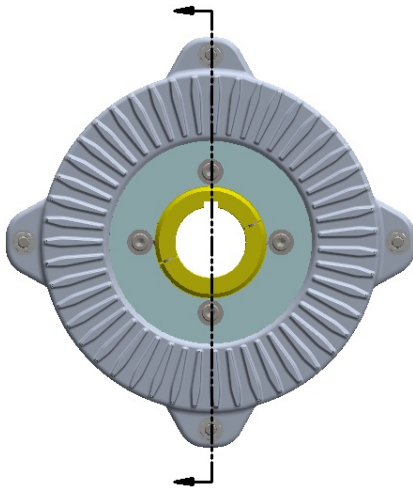

### FDC Basic Dimensions

Model / Size	Radius (A)		Drop-in Length (B)		Overall Length (C)		Weight (including hubs)	
	in	mm	in	mm	in	mm	lbs	kg
FDC-06	4.0	101.6	3.75	95.25	5.5	139.7	22	9.97
FDC-08	5.5	139.7	4.0	101.6	6	152.4	29	13.2
FDC-10	6.0	152.4	4.25	107.9	6.5	158.7	40	18.1
FDC-12	7.0	177.8	4.25	107.9	6.5	158.7	59	26.8
FDC-14	8.8	203.2	4.5	114.3	6.75	114.3	79	35.8

### FDC Operating Specifications

Model / Size	Max. Operating Torque		Max. Peak Torque		Rating @ 1800 RPM (95% Efficiency)	Rating @ 3600 RPM (97.5% Efficiency)
	Lb-ft	Nm	Lb-ft	Nm	HP	HP
FDC-06	22.5	30.5	30	40.7	3-7.5	6-15
FDC-08	60	81	75	101	10-20	20-40
FDC-10	120	163	160	216	25-40	50-80
FDC-12	225	306	275	371	50-75	100-150
FDC-14	375	509	435	587	100-125	200-250

#### Authorized Flux Drive Reseller



#### Burnaby

2809 Norland Ave.  
Burnaby, BC V5B 3A9  
Tel: 604-291-2544  
Fax: 604-291-2510  
sales@flux-tech.ca

#### Kelowna

#106 – 2955 Acland Road  
Kelowna, BC V1X 7X2  
Tel: 250-765-6980  
Fax: 250-765-6981  
sales@flux-tech.ca



Flux Drive Inc. 14209 - 29th Street East Suite 105 Sumner, Washington 98390  
Phone: 253.826.9002 Fax: 253.826.9004 Web: www.fluxdrive.com

